



# *The Babe Ruth Birthplace & Museum*

is a unique venue for parties, receptions, and events. When you book your event with us, you are contributing to the success of our mission and supporting the legacy of Babe Ruth and of all Maryland sports.



216 EMORY STREET  
BALTIMORE, MD 21230

410-727-1539



# Rental Pricing

The Babe Ruth Birthplace Museum is a great place for birthdays, pre-game events, cocktail parties, small wedding receptions, and more! Take advantage of our recently renovated facility and beautiful courtyard - or decide to close the street and have a block party!

	PARTIAL FACILITY & COURTYARD	FULL FACILITY & COURTYARD	FULL FACILITY, COURTYARD, & STREET CLOSURE	BIRTHDAY PARTY AGES 3-12
GUEST CAPACITY	50	125	500	15 CHILDREN & 15 ADULTS
EVENT DURATION	3 HOURS	4 HOURS	4 HOURS	2 HOURS
EVENT STYLE	PRE-GAME PARTY	RECEPTION	RECEPTION OR BLOCK PARTY	
AFTER HOURS	YES	YES	YES	YES
RENTAL FEE MONDAY-THURSDAY	\$500	\$1000	\$2000	\$250 FACILITY \$300 W/ ACTIVITY
RENTAL FEE FRIDAY-SUNDAY	\$500	\$1250	\$2500	\$250 FACILITY \$300 W/ ACTIVITY
INCLUDES	MUSEUM ADMISSION & USE OF RESTROOM FACILITIES	PRIVATE USE OF MUSEUM & REQUIRED STAFF	PRIVATE USE OF MUSEUM & REQUIRED STAFF	MUSEUM ADMISSION & USE OF RESTROOM FACILITIES

To learn more or to schedule your event, call Shawn at 410-727-1539 x3040  
 Note: Full facility pricing applies to rentals on non-game days.

# Preferred Vendors

We've done the searching for you! The Babe Ruth Birthplace Museum recommends working with one of our preferred vendors.

## Bear Bros. Catering

Bear Bros. Catering  
3450 Wilkens Ave.  
Baltimore, MD 21229  
410-644-4499  
bearbroscatering@aol.com



Zeffert & Gold  
6601 Whitestone Road  
Suite E  
Baltimore, MD 21207  
410-944-4481  
kristin@zeffertandgold.com



Classic Catering  
99 Painters Mill Road  
Owings Mills, MD 21117  
410-356-1666



Santoni's  
Marketplace & Catering  
4854 Butler Road  
Reisterstown, MD 21071  
410-833-6610  
catering@santonis.com

Other caterers may be used, provided they meet the following criteria:

1. The vendor must have valid catering and liquor licenses.
2. The vendor must be insured.
3. The vendor must agree to the terms and conditions set forth to vendors (set-up and clean-up procedures, wine policy, etc.)

The Babe Ruth Museum does not permit self-catering with the exception of children's pizza parties and birthday cakes.





Included in our rental prices are:

- 6 six-foot tables
- 4 four-foot tables
- 50 folding chairs

Our facilities can be set-up in many different configurations to fit the needs of your event.

Our add-ons include:

- 5 high-top tables \$50
- Guided Tour \$50
- Artifact Photo Op \$100



Surprise your guests with a photo opportunity. The Super Bowl V Lombardi Trophy or the '83 Orioles World Series Trophy can make an appearance for a flat rate of \$100.





# About Us



The Babe Ruth Birthplace Foundation, Inc. is an independent, 501 (c)(3) not-for-profit educational institution dedicated to perpetuating the historic legacy of Babe Ruth, Baltimore's Orioles, Ravens and Colts, and local and regional sports at the amateur, collegiate and professional levels, by preserving, exhibiting, interpreting and augmenting its collections for a diverse audience.

## To implement its mission, the Museum:

- Provides entertaining cultural and educational experiences through dynamic exhibits and programs at the Babe Ruth Birthplace and in the community;
- Preserves, maintains and commemorates the historic significance of its facility;
- Contributes to the economic development of the region with a prominent visitor destination point;
- Provides effective, dynamic community outreach; and
- Encourages scholarly research by maintaining a comprehensive library and archives.

The Babe Ruth Birthplace Foundation, Inc. operates the Babe Ruth Birthplace & Museum and showcases its collection at various venues in the State of Maryland including Oriole Park at Camden Yards and the Orioles Bar at the Center Club in Baltimore.

## Connect with us!



[baberruthmuseum](https://www.baberuthmuseum.com)



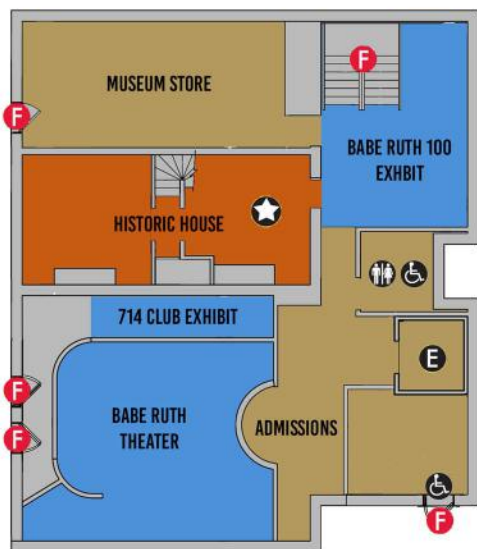
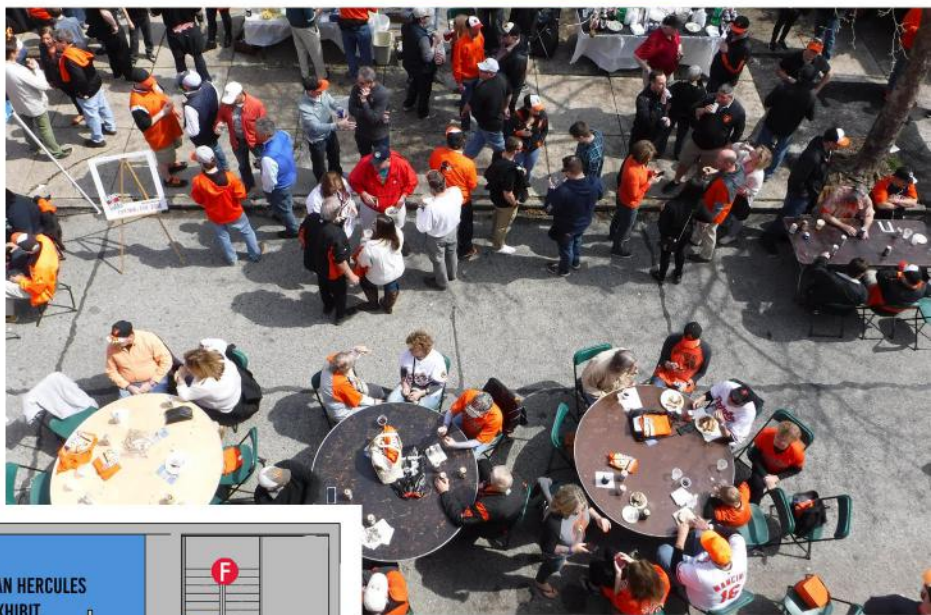

FIRST FLOOR

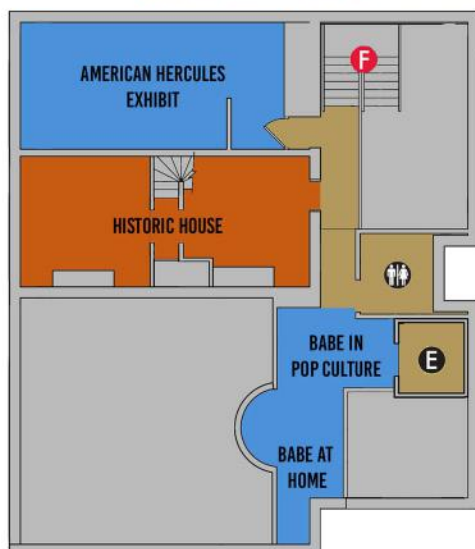

SECOND FLOOR

★ Start Here  
 F Emergency Exit  
 E Elevator  
 Restroom  
 Accessible

